

Medium Term Improvements

Stage One

- Widening of pavements where possible to provide better quality space for pedestrians to walk and stand particularly by bus stops.
- Reconstruction of the carriageway of Victoria Road between the roundabout at the station and St Andrew's Road.
- Widening of Brighton Road on the approach to the traffic signals at Balaclava Road.

Stage Two

- New pavement surfacing to improve the quality of the area.
- New street lighting as the existing columns need to be replaced.
- De-cluttering of the pavements including a review of street furniture.
- Additional street trees where possible.

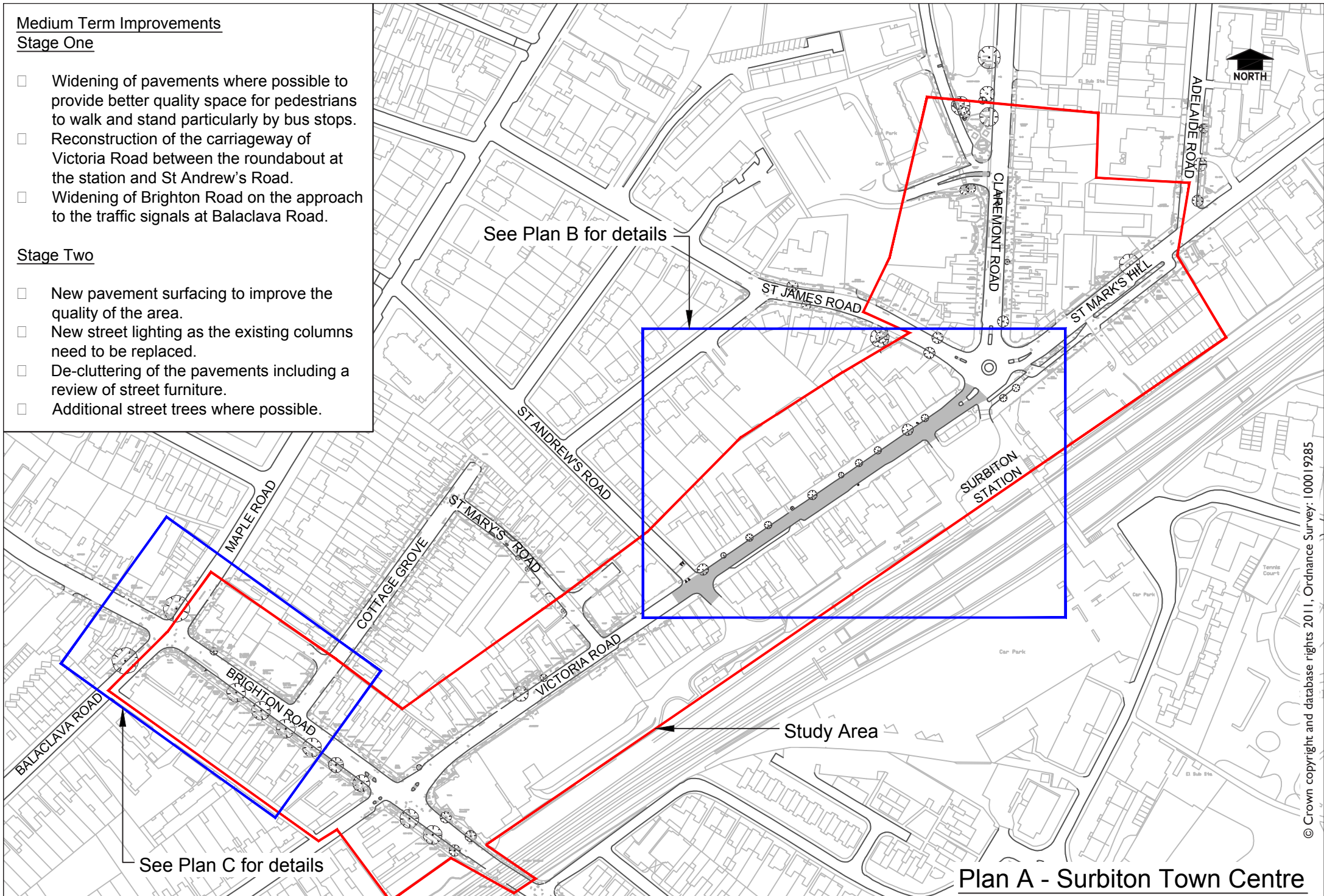

KEY

- Proposed footway widening (Question 2).
- Existing footway.
- Proposed bus stop location (Question 4).
- Existing bus stop location
- Existing pay & display parking (8am - 6:30pm Mon-Sat) to be changed to loading only (7am - 9am Mon-Sat) and pay & display parking (9am - 6:30pm Mon-Sat) (Question 5).
- Existing motorcycle parking
- Proposed no waiting at any time / loading allowed at any time parking restrictions (Question 5).
- Existing no waiting at any time / no loading allowed at any time parking restrictions
- Existing no waiting (8am-6:30pm Mon-Sat) parking restrictions

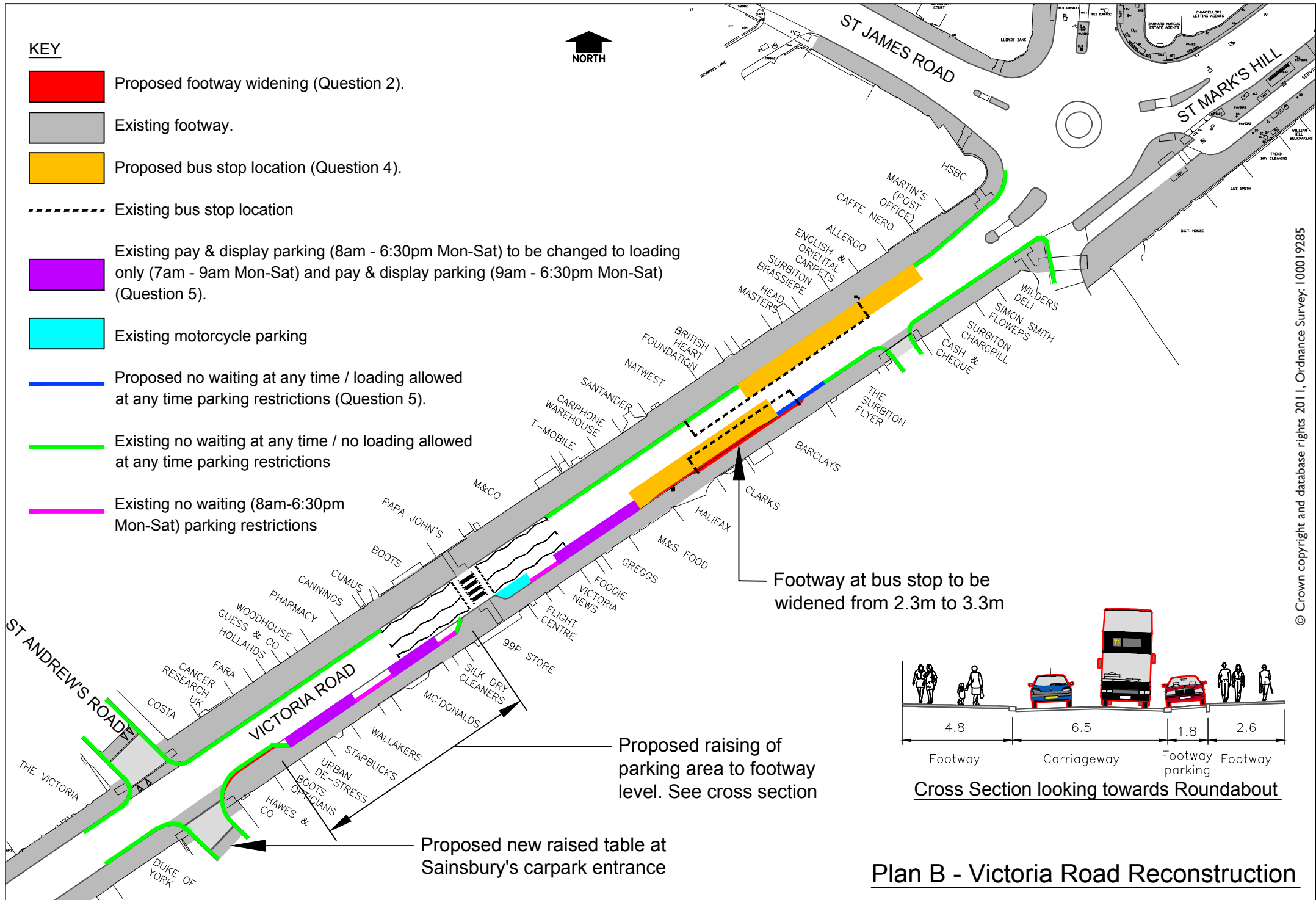

Footway at bus stop to be widened from 2.3m to 3.3m

Proposed raising of parking area to footway level. See cross section

Proposed new raised table at Sainsbury's carpark entrance

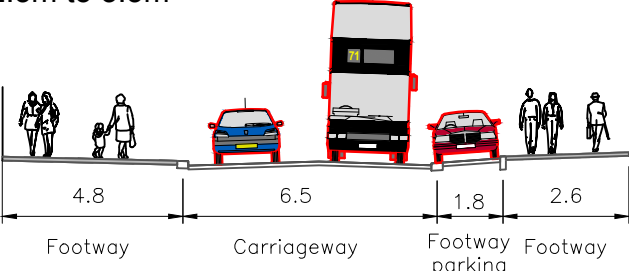

Cross Section looking towards Roundabout

Plan B - Victoria Road Reconstruction

