

THIS DRAWING IS NOT TO BE SCALED. ANY DIMENSIONAL ENQUIRIES MUST BE FORWARDED TO THE ARCHITECT.

- Works by the school
- New Build
- Significant Refurbishment
- Light Refurbishment

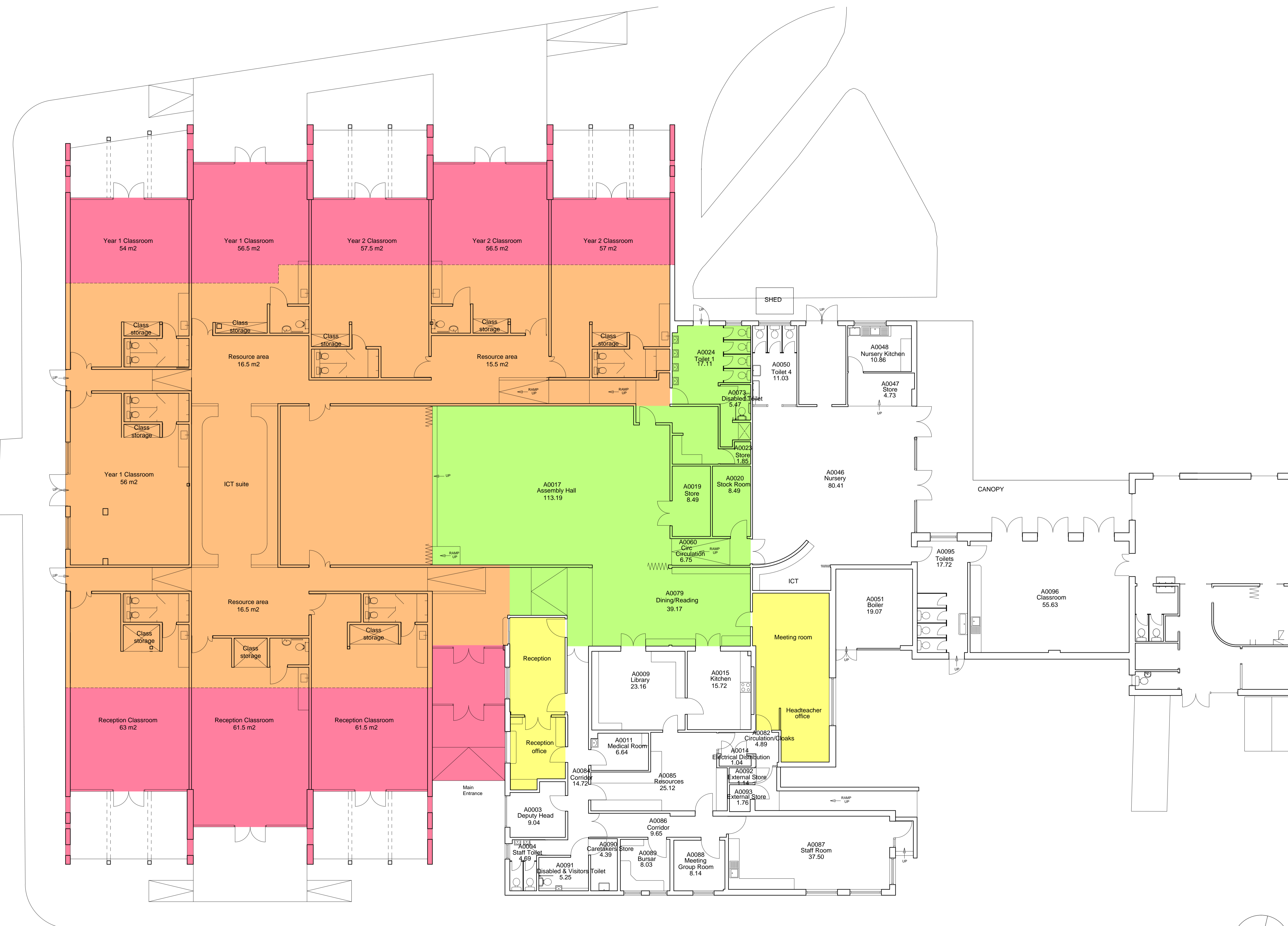

REF REVISION DATE

ID ARCHITECTS
 1 VICTORIA VILLAS
 RICHMOND
 SURREY
 TW9 2GW
 T 020 3274 1000
 F 020 3274 1001
 E info@iid.co.uk
 www.iid.co.uk
 INITIATIVES IN DESIGN

PROJECT
**Alexandra Infant School,
 Kingston upon Thames**

DRAWING TITLE
**Ground Floor Layout Plan as
 Proposed**

SCALE 1:100 @ A1 DATE Apr 2010

DRAWING No. REV
1107/TE1/04

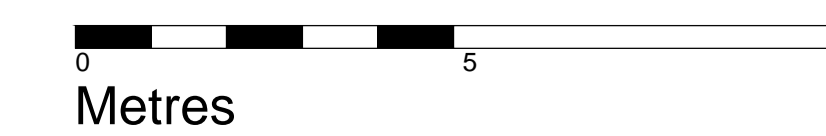
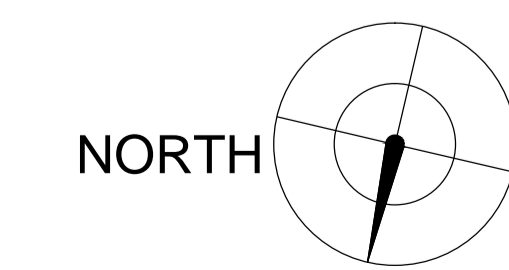

THIS DRAWING IS NOT TO BE SCALED. ANY DIMENSIONAL ENQUIRIES MUST BE FORWARDED TO THE ARCHITECT.

--- Line of Existing Building extents

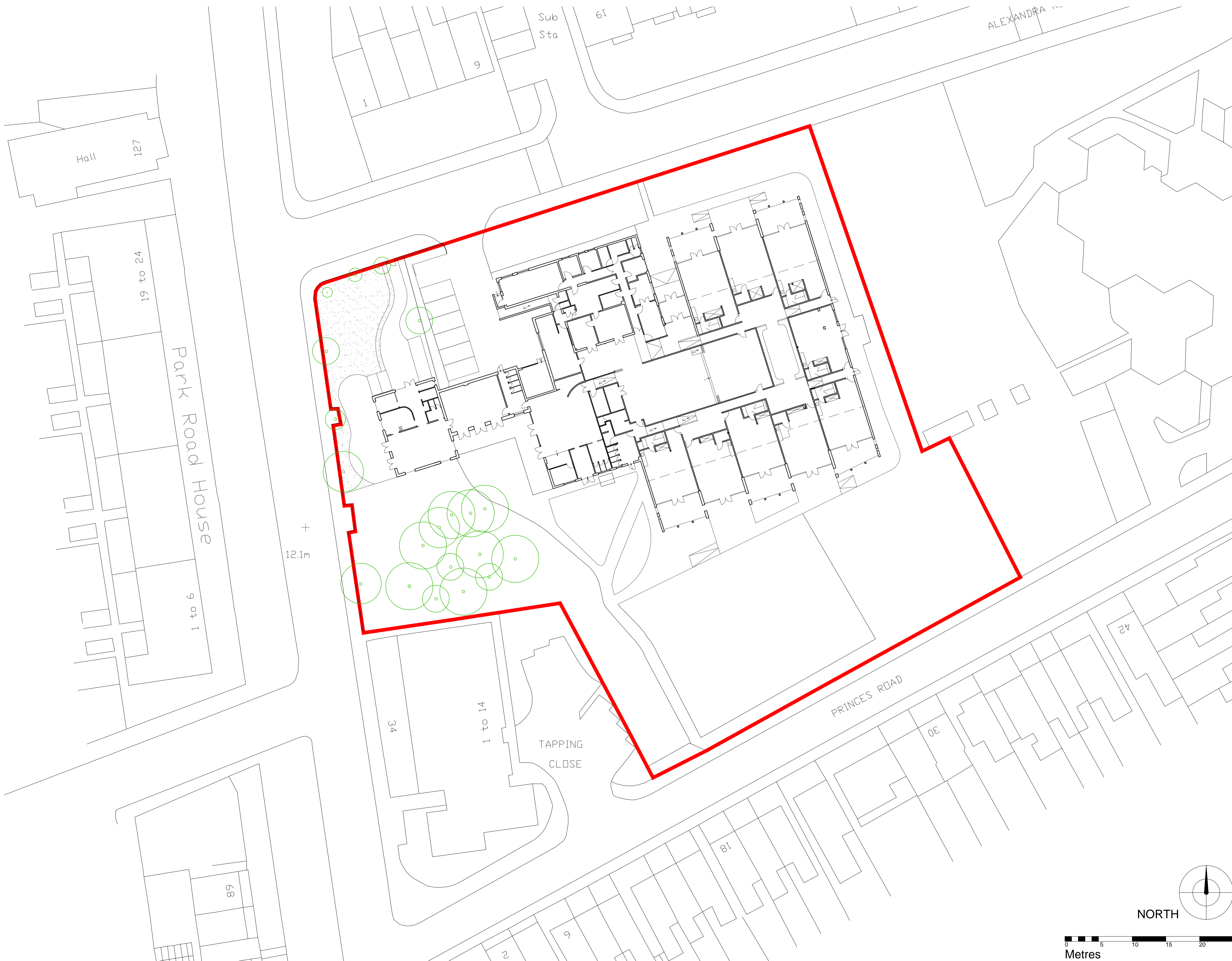

REF	REVISION	DATE

ID ARCHITECTS
 1 VICTORIA VILLAS
 RICHMOND
 SURREY
 TW9 2GW
 T 020 3274 1000
 F 020 3274 1001
 E info@iid.co.uk
 www.iid.co.uk



PROJECT
 Alexandra Infant School,
 Kingston upon Thames

DRAWING TITLE
 Site Layout Plan as Proposed

SCALE 1:250 @ A1 **DATE** Apr 2010

DRAWING No. 1107/TE1/03 **REV**

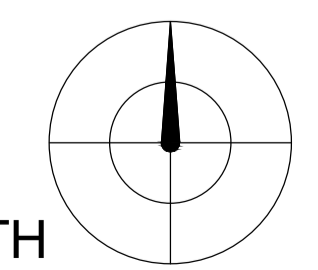

NORTH

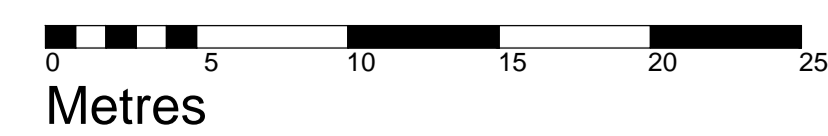

Metres

THIS DRAWING IS NOT TO BE SCALED. ANY DIMENSIONAL ENQUIRIES MUST BE FORWARDED TO THE ARCHITECT.



Main Building Block A Ground Floor

REF	REVISION	DATE

ID ARCHITECTS
 1 VICTORIA VILLAS
 RICHMOND
 SURREY
 TW9 2GW
 T 020 3274 1000
 F 020 3274 1001
 E info@iid.co.uk
 www.iid.co.uk



PROJECT
**Alexandra Infant School,
 Kingston upon Thames**

DRAWING TITLE
**Ground Floor Layout Plan
 as Existing**

SCALE 1:100 @ A1 DATE Apr 2010

DRAWING No. REV
1107/TE1/02

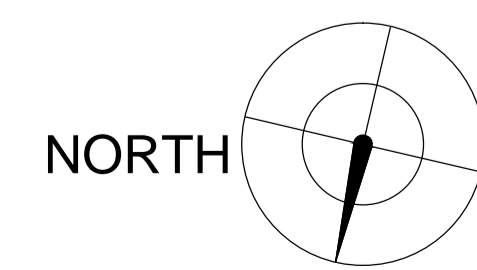

THIS DRAWING IS NOT TO BE SCALED. ANY DIMENSIONAL ENQUIRIES MUST BE FORWARDED TO THE ARCHITECT.

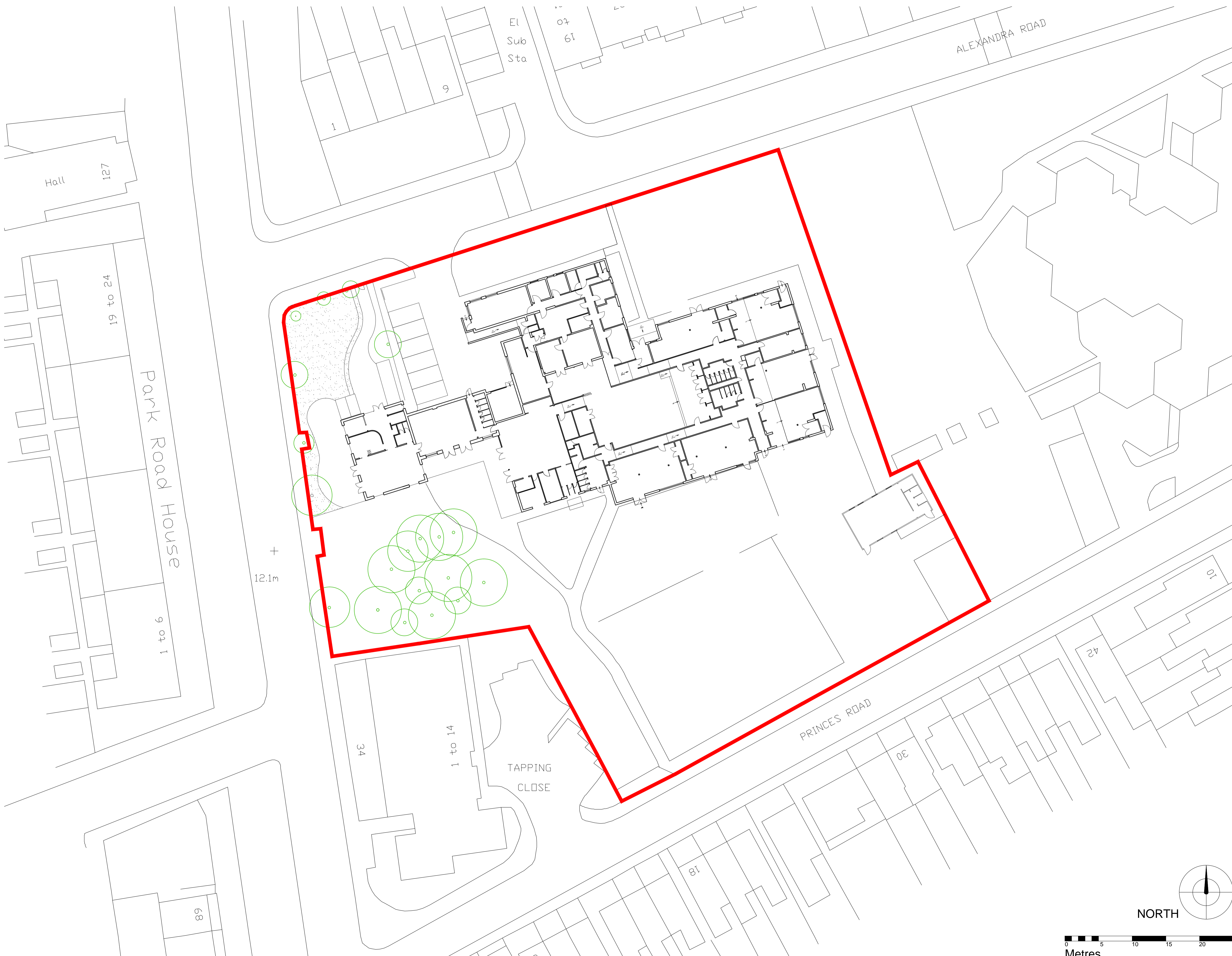

REF REVISION DATE

ID ARCHITECTS
1 VICTORIA VILLAS
RICHMOND
SURREY
TW9 2GW
T 020 3274 1000
F 020 3274 1001
E info@iid.co.uk
www.iid.co.uk



PROJECT
**Alexandra Infant School,
Kingston upon Thames**

DRAWING TITLE
Site Layout Plan as Existing

SCALE 1:250 @ A1 DATE Apr 2010

DRAWING No. REV
1107/TE1/01

